

2/14/19

- Note:
- Steel Shell (WT: 2.0 - 2.5 mm) for impact resistance & shape retention.
 - Precision milled threads conform to the sub's thread & seal profile with tolerance for thread compound. Tough & chemically inert composite (Polyethylene type, Red color, will not react with thread compounds & solvents.)
 - Closed End (with a vent hole $\approx 3mm$) protector with a deep recess provide sample room for lifting hooks & composite barrier keeps dirt & moisture out of the inside of the pipe body.
 - All material requirements shall be according to ISO 11960/API 5CTD

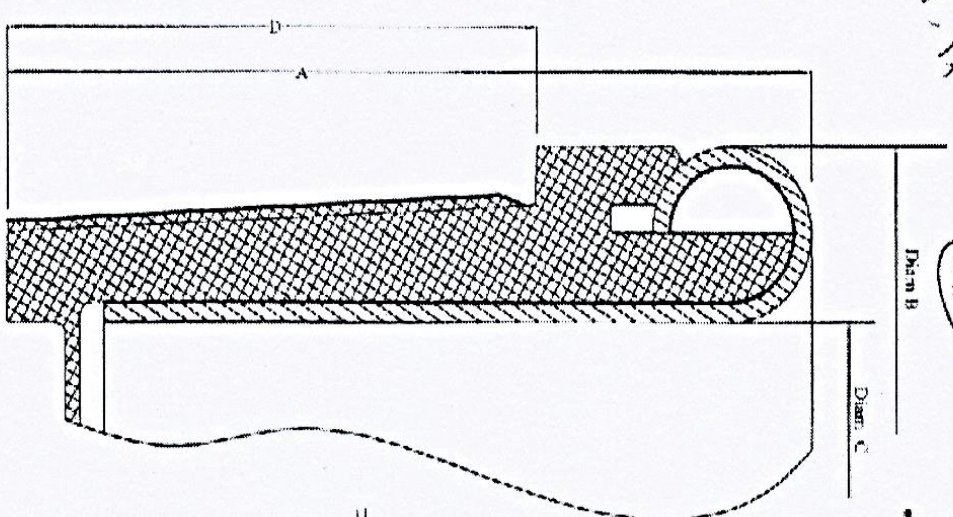

BOX Protector

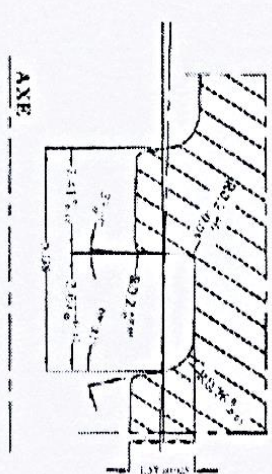
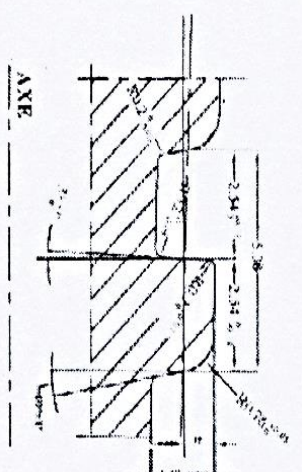

Taper 6.25% - 5Threads per inch - Rev(01)

Nominal size	A		Diam B		Diam C		D		E		Diam F		Diam G		H		Weight Kg
	mm	mm	mm	mm	mm	mm	mm	mm	mm	mm	mm	mm	mm	mm	mm	mm	
7"	165	196	157	129	168	196	160	133	Pin	Box	3.92	3.75					

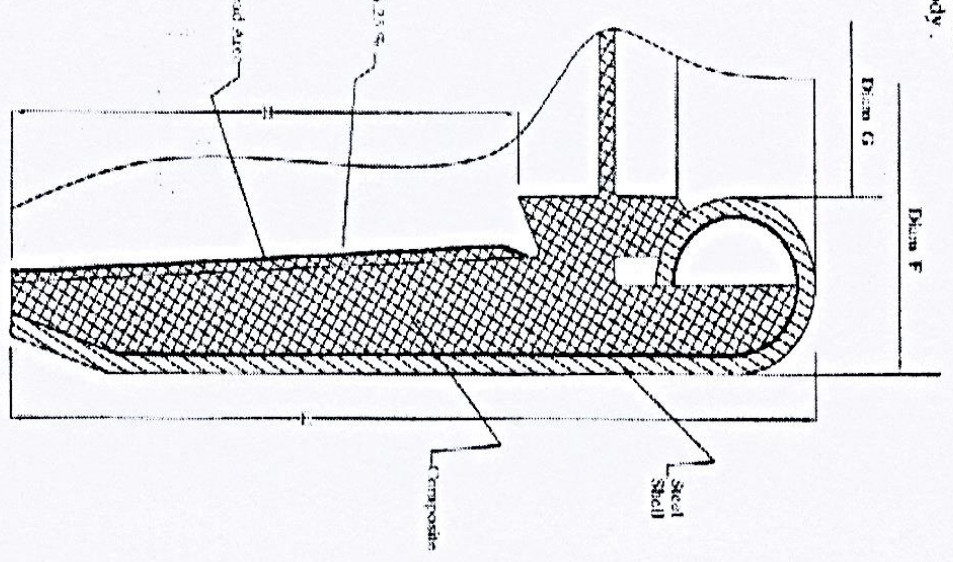

PIN Protector